



MODEL 760 INSTRUCTIONS

TOOLS NEEDED

1. Power Drill
2. 1-1/8" (29mm) Holesaw
3. Round Metal File
4. Center Punch & Hammer
5. 5/16" Hex Socket Driver

Thank you for using
LevALERT Bin Level Indicators!

CONTACT INFORMATION

LevALERT, Inc. 15105 Minnetonka Ind. Rd. Suite 228 Minnetonka, MN 55345	612-643-1784 sales@levalert.com www.levalert.com
--	--



SAFETY PRECAUTIONS: Secure your ladder and use a safety line. Wear safety goggles while drilling hole.

SELECT LOCATION

The LevALERT Model 760 is designed to be installed at any position along a 90° vertical wall section.

Do not install on sloped areas of bin or within 8" (21cm) of obstructions inside the bin such as protruding nuts/bolts, ladders, wall stiffeners, etc.

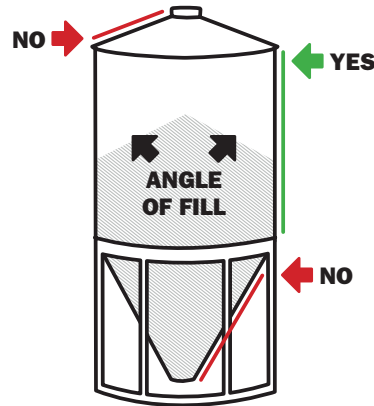

NOTE: Account for the angle of fill when determining installation location.

CORRUGATED BIN WALLS

Install LevALERT Indicator on the INCURVE of the corrugation.

Always use a center punch and hammer to mark location to prevent drill bit from walking.

CAUTION: LevALERT may not work with all types of grain spreaders.

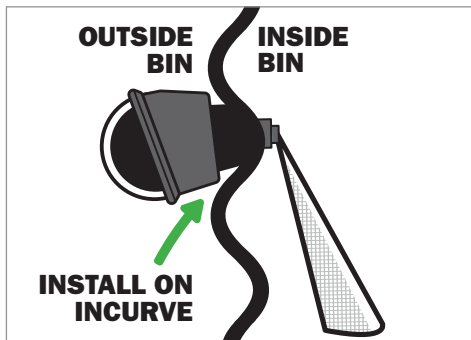

MODEL 760 INSTRUCTIONS

TOOLS NEEDED

1. Power Drill
2. 1-1/8" (29mm) Holesaw
3. Round Metal File
4. Center Punch & Hammer
5. 5/16" Hex Socket Driver

Thank you for using
LevALERT Bin Level Indicators!

CONTACT INFORMATION

LevALERT, Inc. 15105 Minnetonka Ind. Rd. Suite 228 Minnetonka, MN 55345	612-643-1784 sales@levalert.com www.levalert.com
--	--



SAFETY PRECAUTIONS: Secure your ladder and use a safety line. Wear safety goggles while drilling hole.

SELECT LOCATION

The LevALERT Model 760 is designed to be installed at any position along a 90° vertical wall section.

Do not install on sloped areas of bin or within 8" (21cm) of obstructions inside the bin such as protruding nuts/bolts, ladders, wall stiffeners, etc.

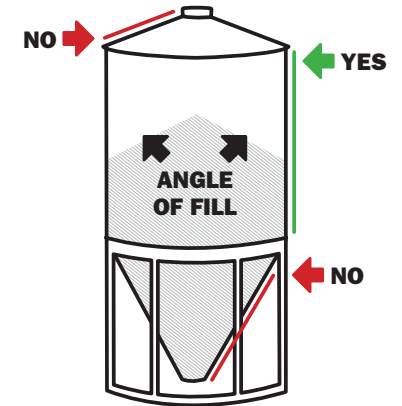

NOTE: Account for the angle of fill when determining installation location.

CORRUGATED BIN WALLS

Install LevALERT Indicator on the INCURVE of the corrugation.

Always use a center punch and hammer to mark location to prevent drill bit from walking.

CAUTION: LevALERT may not work with all types of grain spreaders.

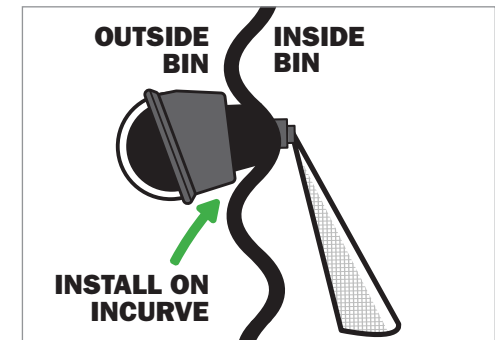



MODEL 760 INSTRUCTIONS

STEP BY STEP INSTALLATION INSTRUCTIONS

1. Wipe bin wall clean with a damp cloth to remove dust, oil and grease.
2. Apply the black diamond-shaped sticker by first removing only the ¼" (6mm) wide center strip of backing. Position the sticker horizontally on the bin wall.

IMPORTANT: Keep the left and right hand tips of the sticker as horizontal as possible. If not horizontal, lift and reposition the sticker. When correct, remove the upper and lower halves of backing and press sticker firmly onto the bin wall.

NOTE: Minimum temperature for adhesion to metal wall bin is 32° F. (0° C.)

3. Use a punch and hammer to mark the 1-1/8" (29mm) center hole of the sticker. This will prevent your drill bit from walking.
4. Drill the center ¼" (6mm) hole in the bin wall.
5. Enlarge the ¼" (6mm) hole to 1-1/8" (29mm) diameter using a 1-1/8" (29 mm) holesaw containing a ¼" rod for greatest accuracy. If using a twist drill bit, gradually increase the hole size to 1-1/8" (29mm).
6. File hole to remove burrs and sharp edges. Remove metal shavings from bin floor.
7. Fold/roll activator into tubular shape and push through hole until foam gasket is against bin wall. See **FIG. 1**.
8. Fasten Indicator Body to bin wall by driving the 2 Self-Drilling Screws into the bin wall. Tighten screws evenly until tight. See **FIG. 2**.

FIG. 1

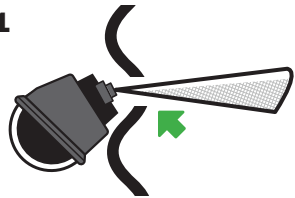

FOLD/ROLL ACTIVATOR AND PUSH THROUGH BIN WALL

FIG. 2

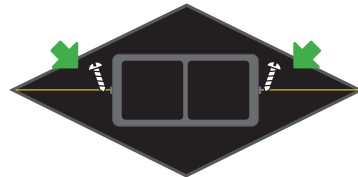

FASTEN SCREWS TO BIN WALL



DURING THE FIRST FILLING/EMPTYING OF YOUR BIN, MONITOR THE OPERATION OF THE LEVALERT INDICATOR CLOSELY TO ENSURE THE UNIT IS WORKING PROPERLY. ADJUSTMENTS MAY BE NECESSARY. NOT FOR USE IN FDA APPLICATIONS.



MODEL 760 INSTRUCTIONS

STEP BY STEP INSTALLATION INSTRUCTIONS

1. Wipe bin wall clean with a damp cloth to remove dust, oil and grease.
2. Apply the black diamond-shaped sticker by first removing only the ¼" (6mm) wide center strip of backing. Position the sticker horizontally on the bin wall.

IMPORTANT: Keep the left and right hand tips of the sticker as horizontal as possible. If not horizontal, lift and reposition the sticker. When correct, remove the upper and lower halves of backing and press sticker firmly onto the bin wall.

NOTE: Minimum temperature for adhesion to metal wall bin is 32° F. (0° C.)

3. Use a punch and hammer to mark the 1-1/8" (29mm) center hole of the sticker. This will prevent your drill bit from walking.
4. Drill the center ¼" (6mm) hole in the bin wall.
5. Enlarge the ¼" (6mm) hole to 1-1/8" (29mm) diameter using a 1-1/8" (29 mm) holesaw containing a ¼" rod for greatest accuracy. If using a twist drill bit, gradually increase the hole size to 1-1/8" (29mm).
6. File hole to remove burrs and sharp edges. Remove metal shavings from bin floor.
7. Fold/roll activator into tubular shape and push through hole until foam gasket is against bin wall. See **FIG. 1**.
8. Fasten Indicator Body to bin wall by driving the 2 Self-Drilling Screws into the bin wall. Tighten screws evenly until tight. See **FIG. 2**.

FIG. 1

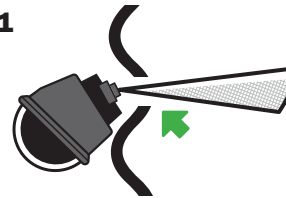

FOLD/ROLL ACTIVATOR AND PUSH THROUGH BIN WALL

FIG. 2

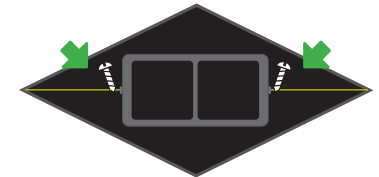

FASTEN SCREWS TO INDICATOR BODY



DURING THE FIRST FILLING/EMPTYING OF YOUR BIN, MONITOR THE OPERATION OF THE LEVALERT INDICATOR CLOSELY TO ENSURE THE UNIT IS WORKING PROPERLY. ADJUSTMENTS MAY BE NECESSARY. NOT FOR USE IN FDA APPLICATIONS.